

THE INFORMATION CONTAINED IN THIS DRAWING IS THE SOLE PROPERTY OF ELECTRO MECHANICAL INDUSTRIES, INC. ANY REPRODUCTION IN PART OR WHOLE WITHOUT THE WRITTEN PERMISSION OF ELECTRO MECHANICAL IND., IS PROHIBITED.

REVISIONS					
REV.	DCN #	DESCRIPTION	DATE	BY	APPROVED
1	01249	UPDATED TOP PLATE AND LEVELING HARDWARE	6/21/2023	BLH	JPB

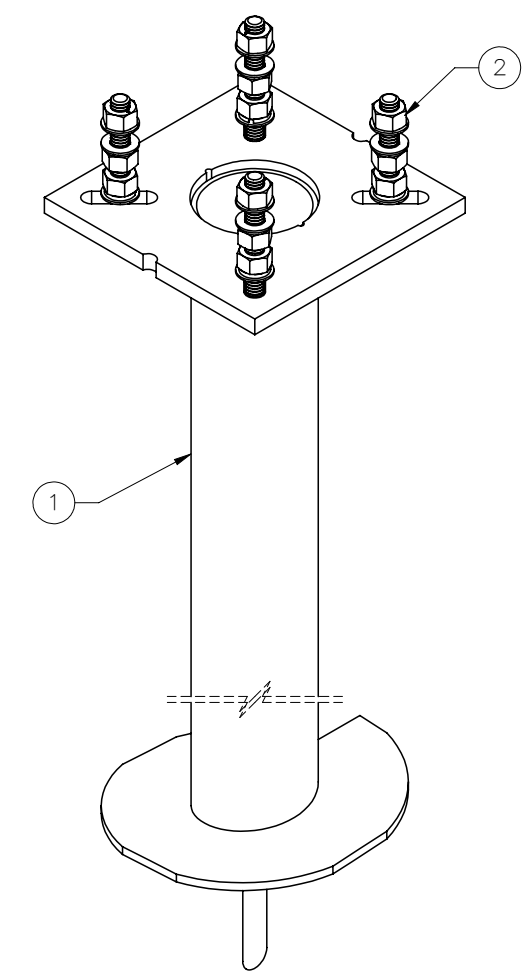
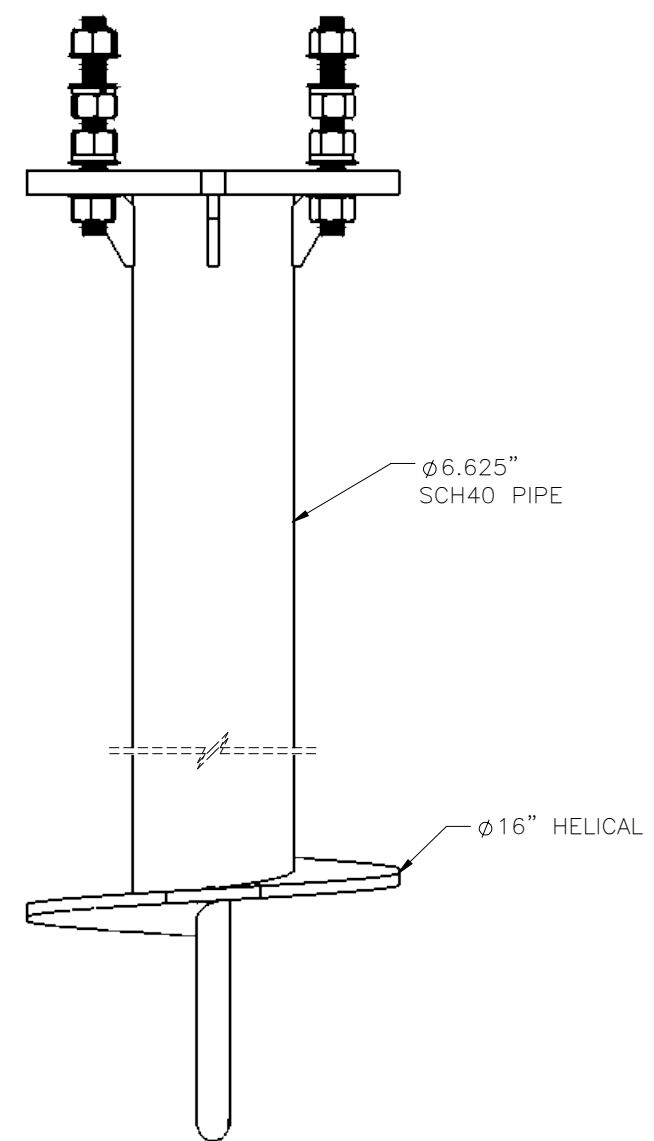
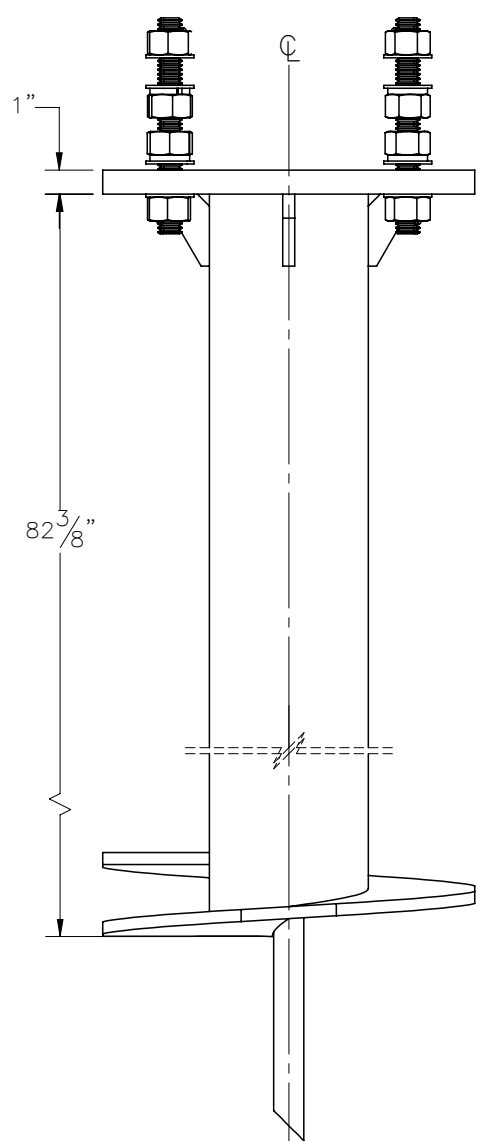
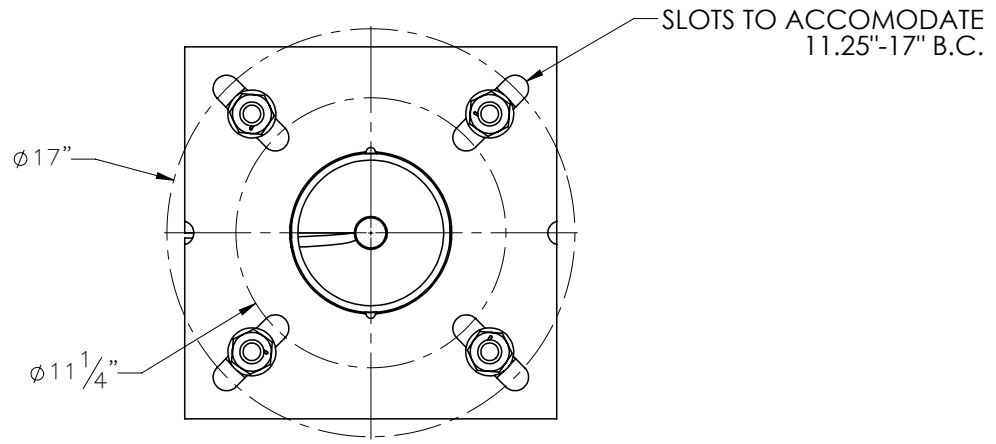

ITEM NO.	QTY REQD	PART NUMBER	DESCRIPTION	LENGTH	WEIGHT
1	1	W-001-878	6" X 7" HELICAL WELDMENT WITH 16" HELICAL GUSSETED		214.07
2	1	1000-0020-0077	QUAD MOUNT 1" LEVELING HARDWARE KIT		15.17

SURFACE FINISH <input checked="" type="checkbox"/> UNLESS OTHERWISE SPECIFIED		UNLESS OTHERWISE SPECIFIED DIMENSIONS ARE IN INCHES		APPROVALS	DATE
MATERIAL SEE PARTS LIST		TOLERANCES		DRAWN	4/9/2020
THIRD ANGLE PROJECTION		.0 ±.06 .00 ±.015 .000 ±.005		CHECKER	4/14/2020
NEXT ASSY		FRACTIONS ± 1/16 ANGLES ± .25°		ENGINEER	4/15/2020
USED ON		HOLES: DRILLED OR PUNCHED ± 1/32		PRODUCTION	4/15/2020
APPLICATIONS		BURNED ± 1/32		J. SUNDERLAND	

ELECTRO MECHANICAL INDUSTRIES, INC. 11230 NEESESHAW DRIVE HOUSTON, TEXAS 77065 1-800-453-0050	
TITLE: 6" X 7" HELICAL WITH 15" X 15" TOP PLATE	
SIZE B	DRAWING NO. 1008-0050-0035
SCALE: 1:8	WEIGHT: 229.24 lbs.
	SHEET 1 OF 1