

THE INFORMATION CONTAINED IN THIS DRAWING IS THE SOLE PROPERTY OF ELECTRO MECHANICAL INDUSTRIES, INC. ANY REPRODUCTION IN PART OR WHOLE WITHOUT THE WRITTEN PERMISSION OF ELECTRO MECHANICAL IND., IS PROHIBITED.

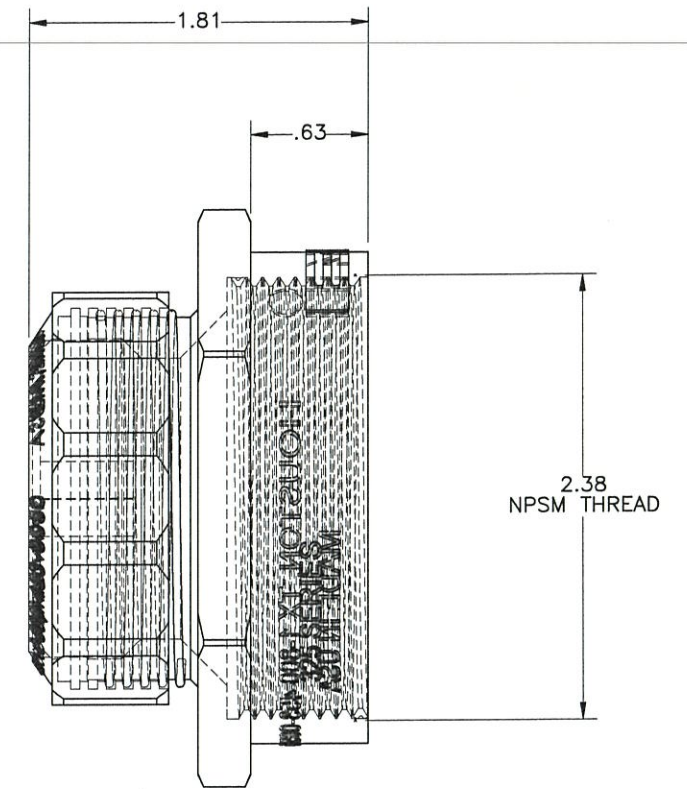
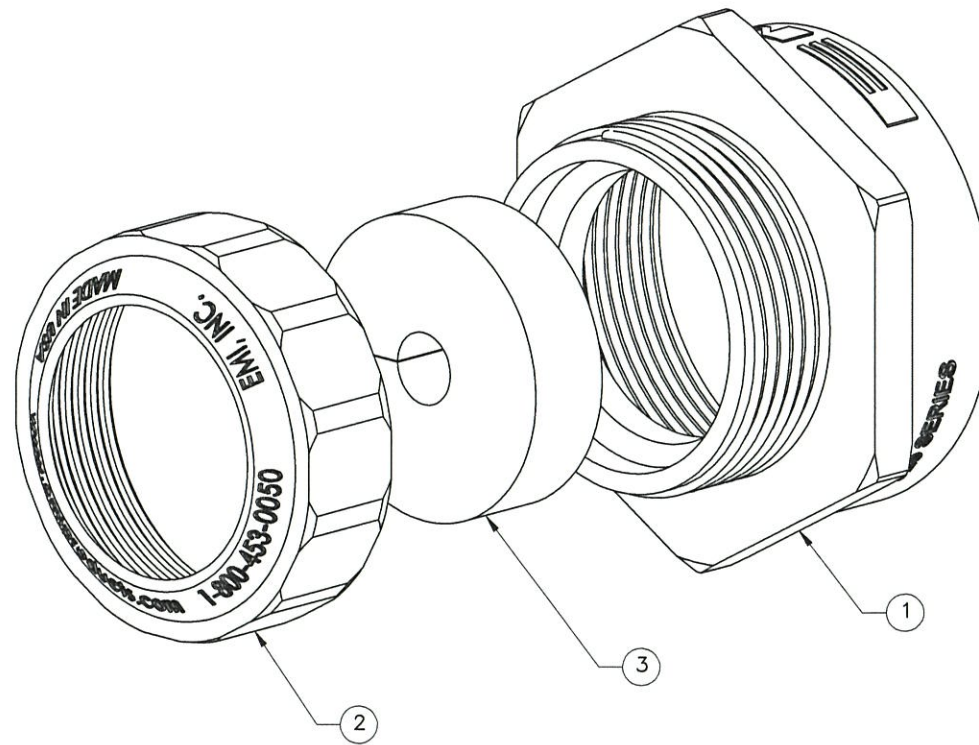
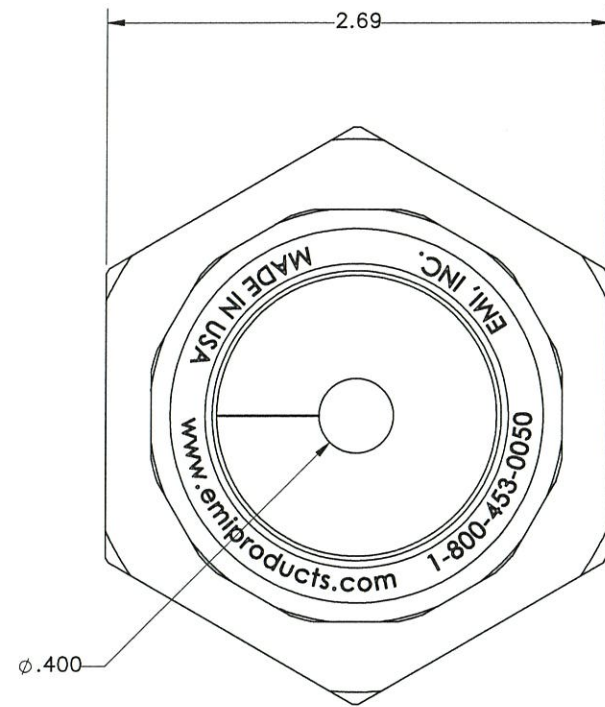

ITEM NO.	QTY REQD	PART NUMBER	DESCRIPTION	LENGTH	WEIGHT
1	1	310-900-2745	325 SERIES BODY		0.10
2	1	310-900-2037	320 SERIES CAP		0.02
3	1	P-001-102	320 SERIES GROMMET (.4)		0.05

SURFACE FINISH <input checked="" type="checkbox"/> UNLESS OTHERWISE SPECIFIED		UNLESS OTHERWISE SPECIFIED DIMENSIONS ARE IN INCHES		APPROVALS	DATE
MATERIAL SEE PARTS LIST		TOLERANCES		DRAWN J. CRITELLI	11.17.16
THIRD ANGLE PROJECTION		.0 ± .06		CHECKED <i>JCS</i>	11.17.16
		.000 ± .005		ENGINEER/DESIGNER <i>JCS</i>	11.17.16
		FRACTIONS ± 1/16		PRODUCTION <i>JCS</i>	11.17.16
		ANGLES ± .25°			
NEXT ASSY USED ON		HOLES:			
		DRILLED OR PUNCHED +1/32			
APPLICATIONS		BURNED ±1/32			

EM I PRODUCTS, LLC 11230 NEESEHAW DRIVE HOUSTON, TEXAS 77065 1-800-453-0050	
TITLE: 325 SERIES PORTAL ENTRY	
SIZE: B	DRAWING NO.: 1017-0070-0002
SCALE: 1:1	WEIGHT: 0.173 lbs.
	SHEET 1 OF 1